

RevNo	Revision note	Date	Signature	Checked
V1.0	Sketch only	28/10/2024		

RoHS Compliant.

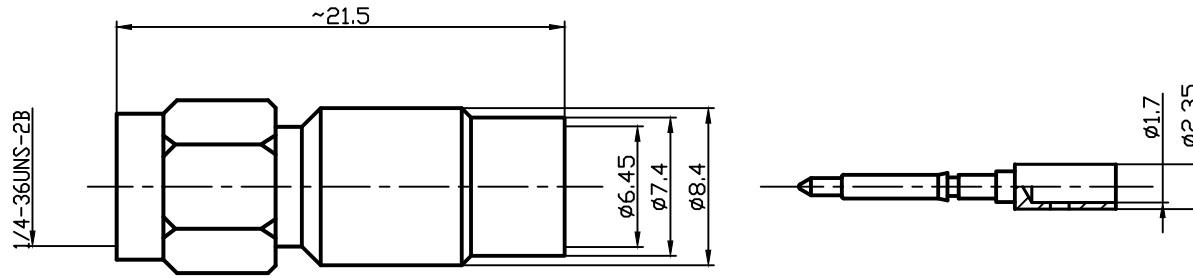

Interface Per: MIL-STD-348, IEC 60169-15
Cable Type: 250 semiflex

Material & Finishing:

1. Center condutor: Brass, Gold Plating
2. Insulators: PTFE
3. Body : Brass, Gold Plating

Electrical Data:

1. Impedance: 50 Ohms
2. Frequency: 0~6GHz
3. VSWR: $\leq 1.1 @ 900\text{MHz}$,
 $\leq 1.15 @ 1800\text{MHz}$,
 $\leq 1.2 @ 3000\text{MHz}$,
 $\leq 1.35 @ 6000\text{MHz}$
4. Insertion loss: $\leq 0.05\text{dB} @ 900\text{MHz}$,
 $\leq 0.05\text{dB} @ 1800\text{MHz}$,
 $\leq 0.05\text{dB} @ 3000\text{MHz}$,
 $\leq 0.1\text{dB} @ 6000\text{MHz}$,
5. Dielectric Withstanding voltage: 1000V Min
6. Voltage Rating : 500V Max

Package : 1 PC per bag
Laser Mark: LenoRF

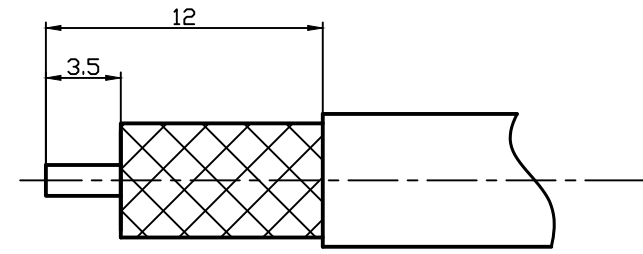

Suggested stripping

Label Content:

LenoRF
Part No: 3.01.336
Part Name: SMA PLUG FOR 250 SEMIFLEX CABLE
QTY: 1 PC
Date: WW/YY (Week/year)

Unless otherwise specified, tolerances as below: .x ±0.15 .xx ±0.1 .xxx ±0.05 Angle: ±2°	Material:	See Notes	Weight	g		
	Finish:	See Notes	Scale	8:1		
	Unit	mm	Page	01		
	REV.	V1.0	p/n	01	DWG NO.	3.01.336
Drawn		DATA:	Projection		Cust P/N.	TBD
Checked		DATA:	Title:			
Approved		DATA:	SMA PLUG FOR 250 SEMIFLEX CABLE			